

ApeosPort-V C5576 R / C3376 R



ApeosPort-V C5576 R / C3376 R

A new multifunction device re-embodied from reused resources

An environmentally friendly reconditioned model using reusable components

A new selection criterion for multifunction devices.

ApeosPort-V C5576 R / C3376 R

Fuji Xerox has promoted the “closed loop” recycling based production system since 1995 for the purpose of reusing resources and reducing CO₂ emissions. The reconditioned model takes this one step further to achieve a component reuse rate of about 80% (by average mass) with unique practical knowledge and advanced reusability technology. Used products that have been recovered are reused based on strict standards to ensure a quality that is equivalent to the newly manufactured equipment.

FUJI XEROX CLOSED LOOP SYSTEM

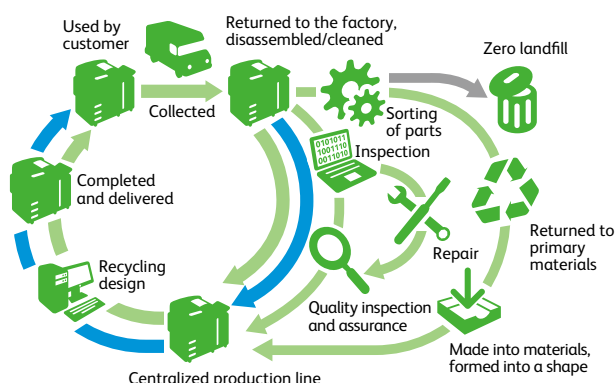

CLOSED LOOP SYSTEM PLUS REUSABLE COMPONENTS

Assuring components with unique standards and reusable component technology Fuji Xerox puts in perspective the entire product life cycle from product planning/development/production to disposal, and recovers used multifunction devices to reuse them as resources. After determining the remaining life-span for each component based on unique standards, we restore their functionality and reuse them (we call this a closed loop system). In recent years, component reusability technology has evolved, including washing, repairing and inspection, and about 80% (by average mass) of components on average are reused for this product. Since only components that meet strict quality standards are reused, we ensure a quality equivalent to that of a newly manufactured equipment.

COMPARISON OF CO₂ REDUCTION DURING PRODUCTION

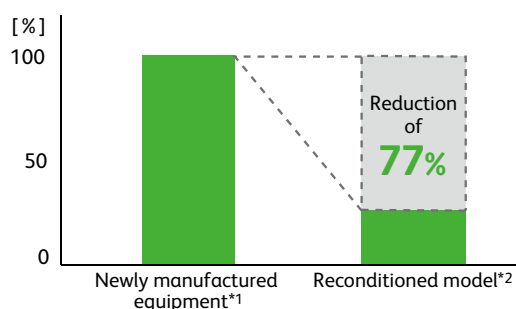

*1: ApeosPort-V C5576

*2: ApeosPort-V C5576 R

Note: The value is the maximum of the model. The CO₂ reduction rate of each device varies depending on the rate of reused parts in the machine.

ENVIRONMENTALLY FRIENDLY RECONDITIONED MODELS

Maximum 77% reduction in CO₂ emissions during production (compared to producing a new Fuji Xerox device) Reused components are utilised to reduce the production of new components and dramatically decrease the amount of CO₂ emitted during production.

The ApeosPort-V C5576 R / C3376 R reconditioned models greatly improve the standard of component reusability to reduce the amount of CO₂ emitted during production by a maximum of 77%.

User- and environment-friendly

"SMART ENERGY MANAGEMENT" FOR SPECIFIC POWER USE

The new ApeosPort-V series uses Smart Energy Management to power only the functions requested by users. This reduces power consumption and CO₂ emissions. To minimise noise, the scanning and output devices do not generate noise when not operating.

A WIDER PRODUCT LINEUP FOR EFFECTIVE DEPLOYMENT AND MANAGEMENT

This series is noted for high environmental performance thanks to advanced technologies such as an IH-Fuser and LED print head. Thus users can share common operability and consumables among several machines, if introduced. The machines, having instantaneous force to wake up from Sleep Mode in 3.1 seconds*, will answer the requirements for high-speed processing and strategic deployment.

*For ApeosPort-V C3376 R. 10.5 seconds for ApeosPort-V C5576 R.

ADOPTION OF LED TO SAVE ENERGY YET OUTPUT

HIGHER QUALITY

Fuji Xerox has utilised LED technology for the exposure unit for low power consumption and a smaller print head, which can image at 1200 x 2400 dpi. It also uses fewer moving parts, so it is quieter during operation.

NOISE AWARE

Fuji Xerox continually addresses the problem of noise in the business environment. We have introduced advanced technologies to our “Quiet Flagship Model” such as the Duplex Automatic Document Feeder*, incorporating new image processing.

*With the ApeosPort-V C5576 R.

Smoother application of information

DUPLEX AUTOMATIC DOCUMENT FEEDER OFFERING HIGH PRODUCTIVITY

Duplex Automatic Document Feeder on the machine is equipped with the "one path duplex scanning feature" to scan both sides of a duplex document at one time, realizing high speed scanning of 150 pages/minute* for both colour and monochrome originals. Besides holding up to 130 sheets of documents, the light weight design, weighing only 11 kg, assists smooth operation for users to open/close it. This provides offices with high productivity.

*With the ApeosPort-V C5576 R. 160 pages/minute when Quiet Mode is set to OFF.

LEVERAGE OF TIMELY INFORMATION WITH PAPERLESS FAX

[Receiving]

Received fax documents can be sorted into different device folders by dial number or G3ID. After viewing the thumbnails, users can choose to print only designated documents. As soon as fax documents are received in a folder, they can also be sent as a fax, printed, sent as an e-mail, transferred via FTP, and transferred via SMB automatically.

[Sending]

Direct Fax (sending fax directly from PC) can also be used. Sent fax documents can also be saved as PDF and sent as e-mail attachments.

[Reject]

Allows administrators to block incoming faxes from certain numbers and anonymous numbers.

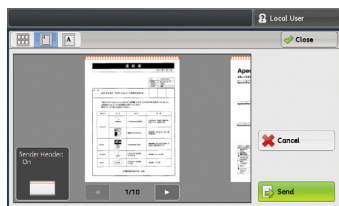

LIGHT AND HEAVY PAPER SUPPORT

The ApeosPort-V series can handle a wider range of paper weights than ever before. The standard paper tray supports weights from 52 gsm up to 300 gsm*. This provides opportunities to create a broad range of business documents and reports, as well as marketing materials such as journals and POS material.

* Documents may not be printed correctly depending on usage conditions.

SERVER-LESS AUTHENTICATION LINKAGE

If user information is registered to a single MFD, it can be automatically shared with other devices. This allows authentication from any device. Users can be registered by simply swiping their IC card, which helps reduce administrator work.

Note: Optional. Requires an IC card reader.

SERVER-LESS ON-DEMAND PRINT

Even if the MFD that you chose to print out is in use, you can print from another MFD. You do not need a special server to use this function. Jobs can be printed even without authentication.

Note: Optional.

[Various benefits]

- Concentration of printing from a specific network connected MFD can be avoided. Optimised device operations help reduce the number of devices in the office.
- Wasteful printing is reduced by deleting or correcting incorrect print jobs from the MFD control panel.
- Printing is executed only after operations on the MFD's control panel. It's effective in reducing forgotten prints and in securing your documents.



ApeosPort-V C5576 R / C3376 R Functions & Specifications

Basic Specifications/Copy Function

Item	Description
Type	ApeosPort-V C5576 R
Memory capacity	4 GB (Max: 4 GB)
Hard disk capacity ^{*1}	160 GB or larger (Usable space: 128 GB)
Colour Capability	Full Colour
Scan Resolution	600 x 600 dpi
Printing Resolution	1200 x 2400 dpi (High Resolution Photo), 600 x 600 dpi (Text / Text-Photo / Photo / Map)
Warm-up Time	30 seconds or less, 24 seconds or less if the main power is on (23 degrees Celsius room temperature)
Original Size	Maximum of 297 x 432 mm (A3, 11 x 17") for both Sheet and Book
Paper Size	Max: SRA3 (320 x 450 mm), 12 x 18" (305 x 457 mm), A3 (12 x 19" (305 x 483 mm) when using Bypass Tray) Min: A5 (Postcard (100 x 148 mm) and Quadrate NO.3 Envelope (120 x 235 mm) when using Bypass Tray)
Image loss width	Lead Edge 4.0 mm, Trail Edge 2.0 mm, Right & Left Edges 2.0 mm
Paper Weight ^{*2}	Paper Tray: 52 to 300 gsm Bypass Tray: 52 to 300 gsm
First Copy Output Time	
B/W ^{*3}	3.7 sec.
Colour ^{*4}	5.2 sec.
Continuous Copy Speed ^{*5}	A4 LEF / B5 LEF: B/W: 55 sheets/minute A4 / B5: B/W: 39 sheets/minute B4: B/W: 32 sheets/minute A3: B/W: 27 sheets/minute
Paper Tray Capacity ^{*6}	Standard: 4 Tray Model: 500 sheets x 4-tray + Bypass Tray 90 sheets
Output Tray Capacity ^{*7}	Upper Center: 250 sheets (A4 LEF), Lower Center: 250 sheets (A4 LEF)
Power Supply	AC220-240 V +/- 10 %, 10 A, 50/60 Hz common
Maximum Power Consumption	2.2 kW or less (AC220 V +/- 10 %), 2.4 kW or less (AC240 V +/- 10 %) Sleep Mode: 1.3 W or less (AC220 V +/- 10 %) Ready Mode: 105 W or less (AC220 V +/- 10 %)
Dimensions Weight ^{*8}	W 640 x D 699 x H 1143 mm 135 kg

*1: The Storage Hard disk capacity is not totally available for customers. *2: It is recommended to use Fuji Xerox recommended paper. Correct print output may not be possible depending on the requirement. *3: A4 LEF / Monochrome priority mode. *4: A4 LEF / Colour priority mode. *5: The speed may be reduced due to the image quality adjustment. *6: 80 gsm paper. *7: 64 gsm paper. *8: Excluding Toner Cartridge.

Scan Function

Item	Description
Type	Colour Scanner
Scan Resolution	600 x 600 dpi, 400 x 400 dpi, 300 x 300 dpi, 200 x 200 dpi
Scan Speed ^{*1}	Same as the "Scan Speed" for the Duplex Automatic Document Feeder
Interface	Ethernet 100BASE-TX / 10BASE-T

*1: The scanning speed varies depending on the documents.

Fax Function (Optional)

Item	Description
Original Size	Max: A3, 11 x 17", Long document (Longest 600 mm)
Recording Paper Size	Max: A3, 11 x 17" Min: A5
Transmission Time	2 seconds and more but fewer than 3 seconds ^{*1}
Transmission Mode	ITU-T G3
Applicable Lines	Telephone subscriber line, PBX, Fax communication (PSTN), Maximum 3 ports ^{*2} (G3-3 ports)

*1: When A4 size document with approximately 700 characters is transmitted in standard image-quality (8 x 3.85 lines/mm) and in high-speed mode (28.8 kbps or faster, JBIG). Only indicates the time for transmitting the image information and does not include the communication control time. The total communication time will vary depending on the contents of the document, the type of machine receiving the fax, and line condition. *2: No of FAX lines is up to 3 ports. Port refers to number of channels for FAX.

Fuji Xerox Co., Ltd. recognizes the importance of environmental conservation and activity works toward the promotion of recycling.
Recycled parts that meet our quality standards are used in ApeosPort-V C5576 R / C3376 R.
Official product name is ApeosPort-V C5576 R / C3376 R.

Notes

- 1) If the storage media (such as hard disk drives) of the base unit fail, loss of received data, accumulated data, registered setting data, etc. may occur. In no event shall Fuji Xerox be liable for any damages whatsoever arising from loss of data.
- 2) Functional spare parts will be available for at least 5 years after the product is no longer manufactured.

- Appearance of reconditioned model is same as newly manufactured equipment.
- All product names and company names mentioned in this brochure are trademarks or registered trademarks of their respective companies.
- The product specifications, appearance and other details in this brochure are subject to change without notice for improvements.
- The available model varies depending on the country/region. Please ask the sales representatives for details.

Reproduction Prohibitions Please note that reproduction of the following is prohibited by law : Domestic and foreign currencies, government-issued securities, and national bonds and local bond certificates. Unused postage stamps, post cards, etc. Certificate stamps stipulated by law. Reproducing works forming the subject matter of copyright (literary works, musical works, paintings, engravings, maps, cinematographic works, drawings, photographic works, etc.) is not permitted unless the reproduction is for the purpose of personal use, family use or other similar uses within a limited circle.

สำหรับท่านที่สนใจ หรือต้องการข้อมูลเพิ่มเติมกรุณาติดต่อ

บริษัท ฟุจิ ซีร็อกซ์ (ประเทศไทย) จำกัด

123 อาคารชินนาเวอร์ส เอ ชั้น 23-26

ถนนวิภาวดีรังสิต จอมพล จตุจักร กรุงเทพฯ 10900

โทร: 02-660-8000 แฟกซ์: 02-617-6748-9

Call Center: 02-660-8400

Fuji Xerox (Thailand) Co., Ltd.

123 Suntowers A Building, 23rd-26th Floor,

Vibhavadi-Rangsit Road, Chomphon,

Chatuchak, Bangkok 10900

Tel: 02-660-8000 Fax: 02-617-6748-9

Call Center: 02-660-8400

<http://www.fujixerox.co.th>

Print Function

Item	Description
Type	Built-in type
Continuous Print Speed ^{*1}	Same as the Basic Specifications / Copy Function
Print Resolution	Standard: [PCL Driver] Standard: 1200 x 2400 dpi, High Quality: 1200 x 2400 dpi, High Resolution: 1200 x 1200 dpi Optional: [Adobe® PostScript® 3™ Driver] High Speed (Standard): 600 x 600 dpi, High Quality: 1200 x 2400 dpi, High Resolution: 1200 x 1200 dpi
Page Description Language	Standard: PCL5 / PCL6 Optional: Adobe® PostScript® 3™
Supported Operating System	Standard: [PCL Driver] Windows 10 (32bit), Windows 10 (64bit), Windows 8.1 (32bit), Windows 8.1 (64bit), Windows 7 (32bit), Windows 7 (64bit), Windows Server 2019 (64bit), Windows Server 2016 (64bit), Windows Server 2012 R2 (64bit), Windows Server 2012 (64bit), Windows Server 2008 R2 (64bit), Windows Server 2008 (32bit), Windows Server 2008 (64bit) Optional: [Mac OS X Driver] macOS 10.14 / 10.13 / 10.12, OS X 10.11 / 10.10 [Adobe® PostScript® 3™ Driver] Windows 10 (32bit), Windows 10 (64bit), Windows 8.1 (32bit), Windows 8.1 (64bit), Windows 7 (32bit), Windows 7 (64bit), Windows Server 2019 (64bit), Windows Server 2016 (64bit), Windows Server 2012 R2 (64bit), Windows Server 2012 (64bit), Windows Server 2008 R2 (64bit), Windows Server 2008 (32bit), Windows Server 2008 (64bit)macOS 10.14 / 10.13 / 10.12, OS X 10.11 / 10.10
Interface	Standard: Ethernet 100BASE-TX / 10BASE-T, USB2.0

*1: The speed may be reduced due to the image quality adjustment. The printing speed may be reduced depending on the document.

Duplex Automatic Document Feeder B1-C

Item	ApeosPort-V C3376 R
Original Size / Paper Weight	Max: A3, 11 x 17" Min: A5 ^{*1} 38 to 128 gsm (In Duplex: 50 to 128 gsm)
Capacity ^{*2}	110 sheets
Scan Speed	Copy (A4 LEF Simplex): B/W: 35 sheets/minute Colour: 35 sheets/minute Scan: B/W: 70 sheets/minute, Colour: 70 sheets/minute [Fuji Xerox Standard Paper (A4), 200 dpi, to Folder.]

*1: The minimum custom size is 125 x 85 mm. *2: 64 gsm paper.

Duplex Automatic Document Feeder B1-PC

Item	ApeosPort-V C5576 R
Original Size / Paper Weight	Max: A3, 11 x 17" Min: A5 ^{*1} 38 to 128 gsm (In Duplex: 50 to 128 gsm)
Capacity ^{*2}	130 sheets
Scan Speed ^{*3}	Copy (A4 LEF Simplex): B/W: 55 sheets/minute Colour: 50 sheets/minute Scan: B/W: 80 sheets/minute, Colour: 80 sheets/minute (1 pass, 2 sided scanning: B/W: 150 ppm ^{*4} , Colour: 150 ppm ^{*4}) [Fuji Xerox Standard Paper (A4), 200 dpi, to Folder.]
Dimensions Weight	W 560 x D 498 x H 140 mm 11 kg

*1: The minimum custom size is 125 x 85 mm. *2: 64 gsm paper. *3: Simplex scanning speed of Duplex Automatic Document Feeder B1-PC is reduced when Paper Security Function is enabled. *4: 160 ppm for both B/W and colour when Quiet Mode is disabled. This setting can be changed to suit the customer's usage.

Option

Item	Product Code	Description
External IC Card Reader B	EC103320	IC Card Reader
Adobe PostScript 3 Kit	EC103031	Adobe PostScript 3
Fax Kit	EC102502	One line, Standard G3 FAX

Consumables

Item	Product Code	Capacity / Life
Toner Cartridge-Black	CT201370	26,000 pages ^{*1}
Toner Cartridge-Cyan	CT201371	15,000 pages ^{*1}
Toner Cartridge-Magenta	CT201372	15,000 pages ^{*1}
Toner Cartridge-Yellow	CT201373	15,000 pages ^{*1}
Longlife Drum Cartridge (K, C, M, Y)	CT350851	143,000 pages ^{*2} each colour
Waste Toner Bottle	CWA00751	44,000 pages ^{*1}

*1: The life of toner cartridge 5% area coverage A4 each colour, consumption shall differ according to print paper size, image type, as well as density. *2: The reference value for drum life (number of possible prints) may differ from this reference value due to the frequency and operations performed. Machine initially comes with one Toner Cartridge set and Drum Cartridge same as reorder.



Adobe PostScript® 3™



For Your Safety

Before using the product, read the Instruction Manual carefully for proper use. Use the product with the power source and voltage specified. Be sure to establish ground connection. Otherwise, electronic shock may result in the case of a failure or short circuit.



ตัวแทนจำหน่าย